

# INCARCERATION, REFORM, AND DESIGN

~~PROBLEM~~....OPPORTUNITY

# BACKGROUND CHECK

Thomas Moore, AIA, LEED AP-BD&G

*“INSTEAD OF THINKING  
OUTSIDE THE BOX, GET RID  
OF THE BOX..”*

*DEEPAK CHOPRA*

# WHAT IS THE INTENT OF INCARCERATION..?

Incarceration



*“INSTEAD OF THINKING  
OUTSIDE THE BOX, GET RID  
OF THE BOX..”*

*DEEPAK CHOPRA*



A new way of thinking...

*“INSTEAD OF THINKING  
OUTSIDE THE BOX, GET  
RID OF THE BOX..”  
DEEPAK CHOPRA*



A new way of thinking....





# *ADAPTIVE TRANSFORMATION; TURNING AN EDUCATIONAL CAMPUS INTO A 'REFORMATION CAMPUS'*

Incarceration = Adaptive Reuse vs New





# ADAPTIVE TRANSFORMATION; TURNING AN EDUCATIONAL CAMPUS INTO A 'REFORMATION CAMPUS'

Incarceration = Adaptive Reuse vs New

# ADAPTIVE TRANSFORMATION; TURNING AN EDUCATIONAL CAMPUS INTO A REFORMATION CAMPUS

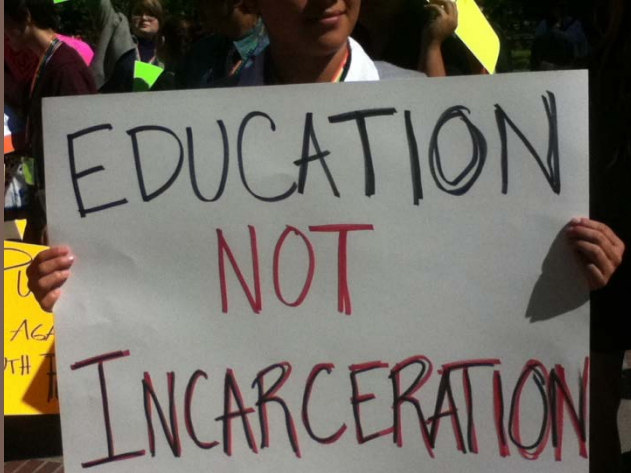

## Incarceration

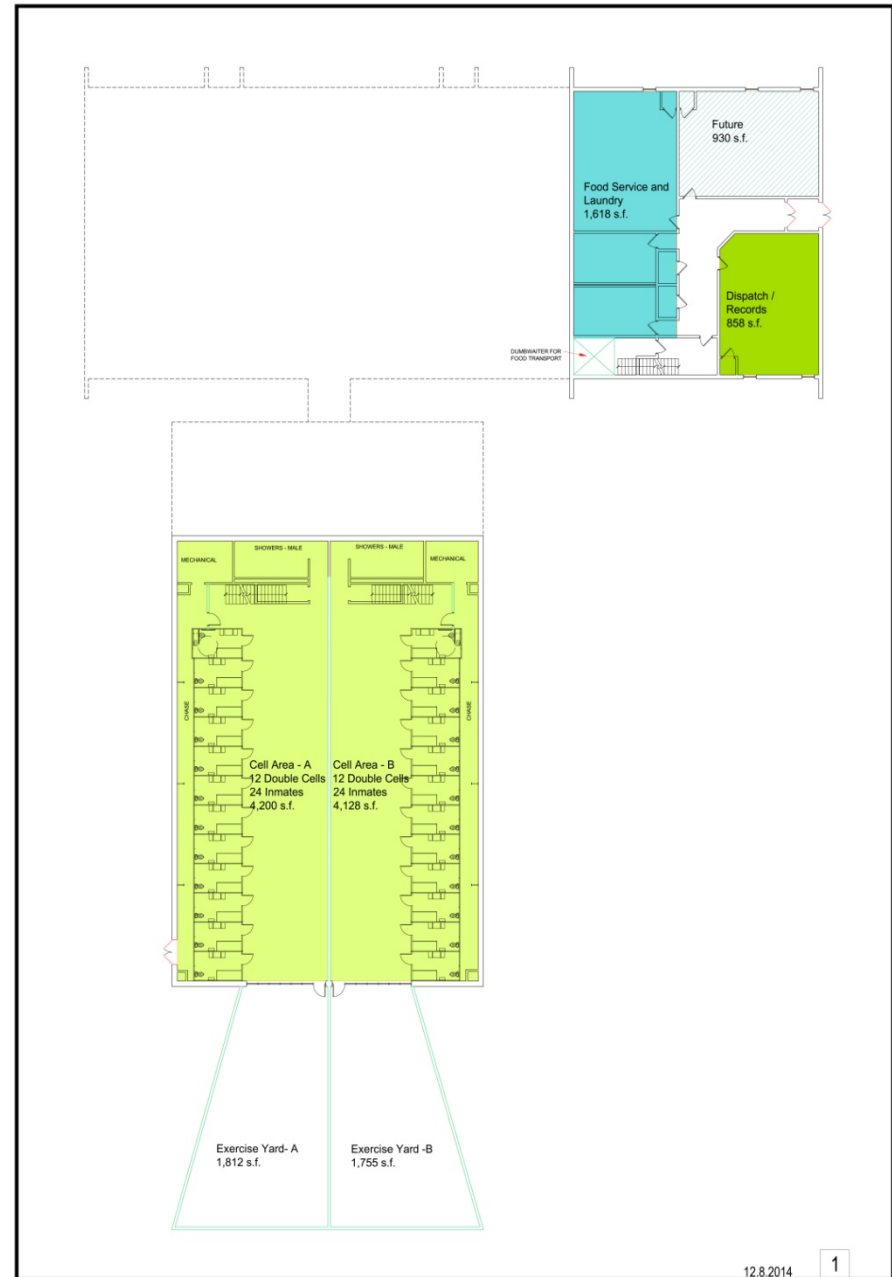

# ADAPTIVE TRANSFORMATION; AN EDUCATIONAL CAMPUS INTO A REFORMATION CAMPUS

- 96 Bed Jail.
- Kitchen and Laundry Services.
- Sheriff's Department.
- Courts Area.
- Dispatch / 911.
- Room for Expansion.

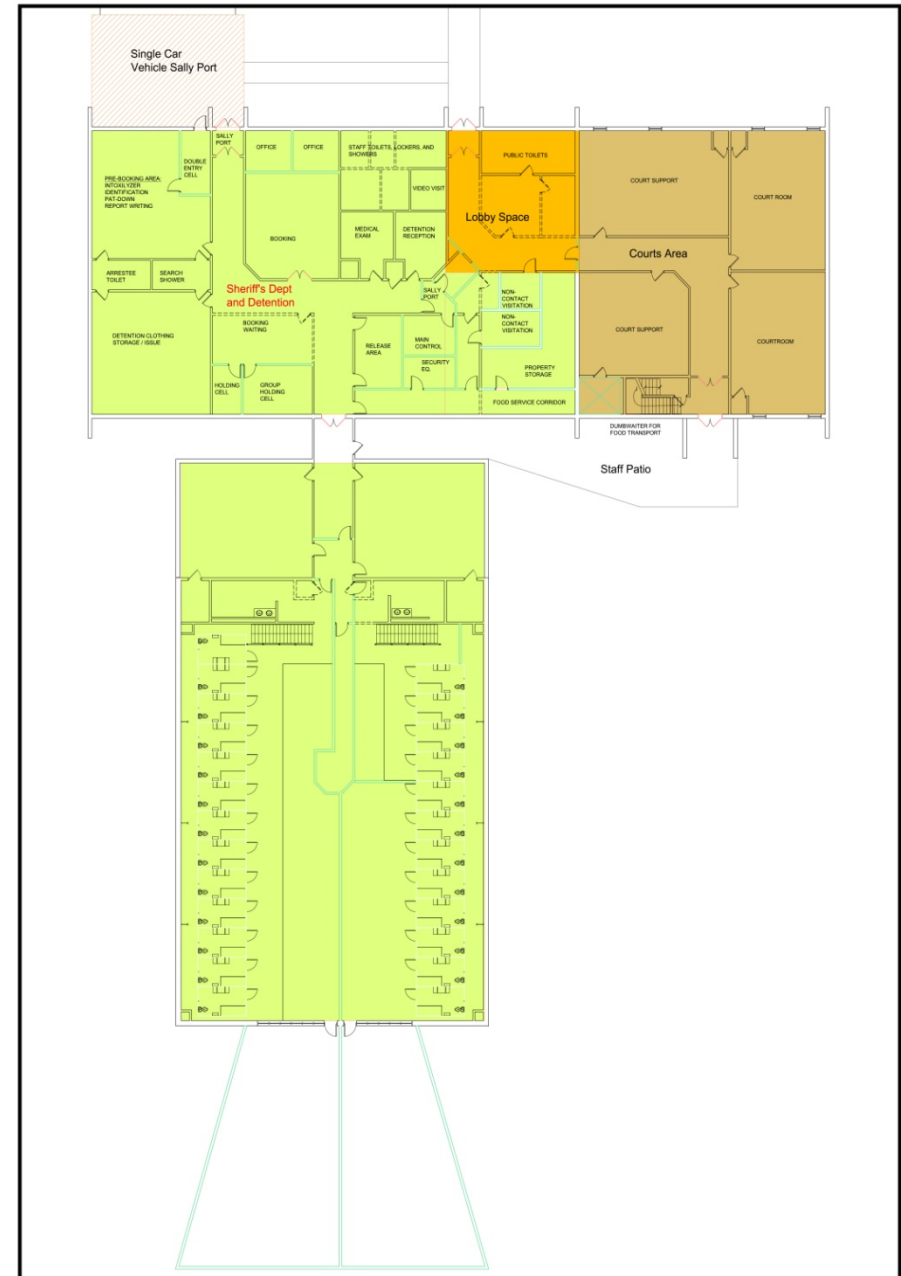

# *ADAPTIVE TRANSFORMATION; AN EDUCATIONAL CAMPUS INTO A REFORMATION CAMPUS*

57 SCHOOL DISTRICTS CLOSED  
FOR CONSOLIDATION EFFORTS...

OPPORTUNITY



Incarceration



*ADAPTIVE  
TRANSFORMATION;  
AN EDUCATIONAL CAMPUS INTO A  
REFORMATION CAMPUS*

57 (81 UofA) SCHOOL DISTRICTS CLOSED  
FOR CONSOLIDATION EFFORTS...

OPPORTUNITY



Incarceration





# POTENTIAL

Incarceration = Adaptive Reuse vs New

# POTENTIAL

Peru, Indiana – Old Grissom Air force Base



Incarceration = Adaptive Reuse vs New



# REGIONAL DETENTION FACILITIES

- Inmates closer to family, friends, and support groups.
- Smaller facilities.
- Spreads economic growth / jobs.
- Coincides with existing buildings to be reused. (School campuses)

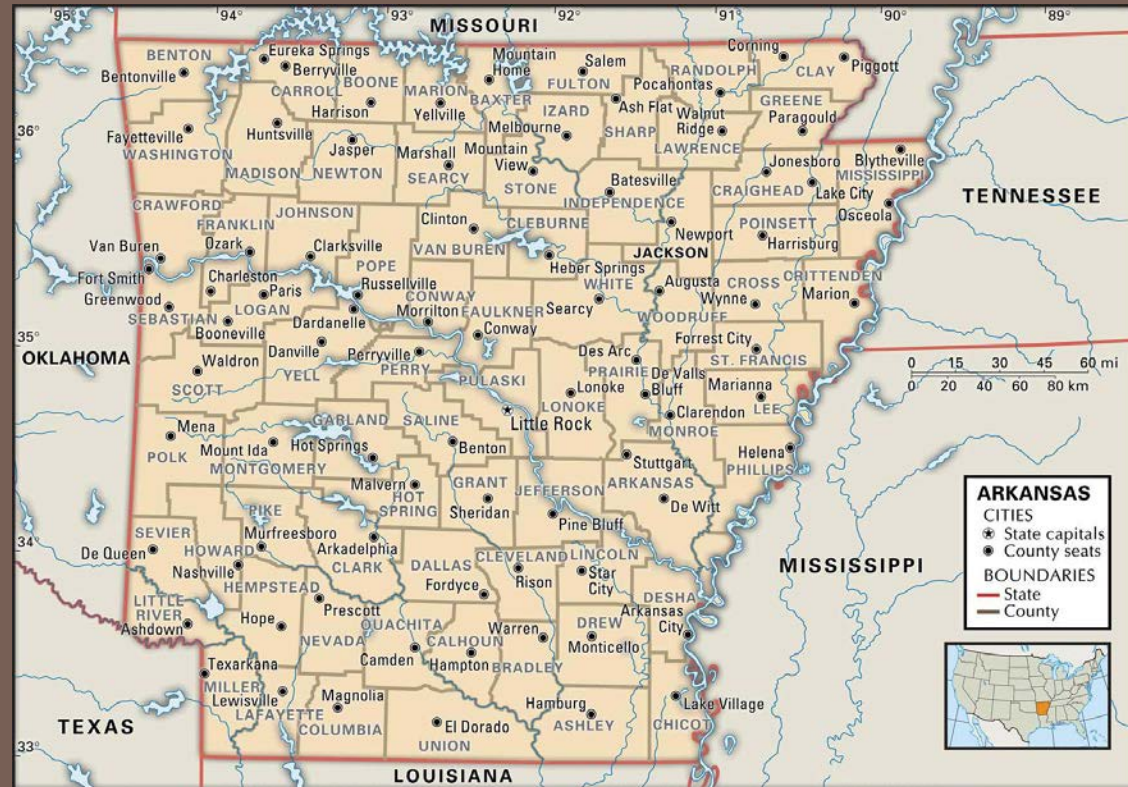

Reform

# CO-FACILITIES

## Symbiotic Relationships



### Wholistic Approach:

- Mental Health Crisis Facilities
- Re-Entry Houses
- Detention
- Program and Classrooms

## Regional Detention Campuses

Reform

# PROGRAM SPACES

Program spaces must be designed large enough so they are not outgrown in a short amount of time.

KITCHEN  
CULINARY PROGRAMS  
SUPPORT EXPANSION



Reform



# PROGRAM SPACES

## CLASSROOM SPACES

Program spaces must be  
Designed large enough so  
they are not outgrown in a  
short amount of time.



Reform

# *MENTAL HEALTH*

## **America's Largest Mental Hospital Is a Jail**

At Cook County, where a third of those incarcerated suffer from psychological disorders, officials are looking for ways to treat inmates less like prisoners and more like patients.

The Deputy Director of the facility is a Clinical Psychologist....

Reform

# MENTAL HEALTH

At least 400,000 inmates currently behind bars in the US suffer from some type of mental illness.



North Carolina Dept. of Corrections Mental Health Unit

Prisoners with mental health problems will be treated inside jails rather than in hospitals  
Chris Grayling, Justice Secretary

Reform



# MENTAL HEALTH

- Confinement
- Rehabilitation
- Treatment
- Supervision



North Carolina Dept. of Corrections Mental Health Unit

Reform

# MENTAL HEALTH

*A good white-paper to read:  
Adults with Behavioral Health Needs under  
Correctional Supervision: A Shared Framework  
for Reducing Recidivism and Promoting Recovery*

Understanding “Co-Occurrence” between mental health and substance abuse..

Where will our resources have the biggest impact...?? A high initial cost for treatment may reduce recidivism...therefore lowering the overall inmate costs over time.

Reform

## *MENTAL HEALTH*

- Incorporate REGIONAL MENTAL HEALTH CRISIS TREATMENT CENTERS.
- Develop COMMUNITY-BASED TREATMENT CENTERS.
- Locate in easily accessible areas.
- Consider the symbiotic relationships to other services and programs.

# AGING POPULATION

The 'pool' from which  
Possible staff will be  
recruited is getting  
older too..

GROWTH IN STATE AND FEDERAL PRISON POPULATION, BY AGE, 1995-2010

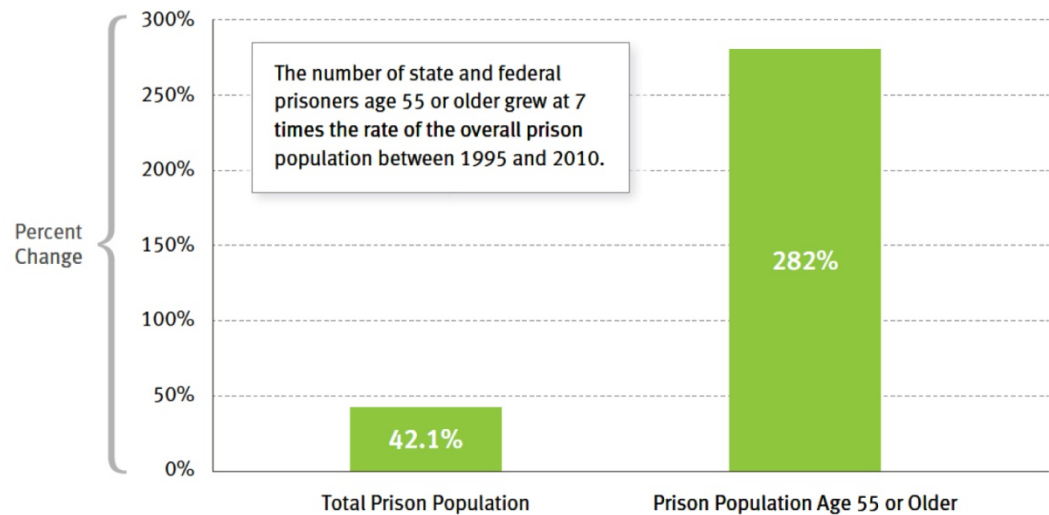

Source: Bureau of Justice Statistics, Prisoner Series, 1995-2010

Note: Based on number of sentenced prisoners under jurisdiction of federal and state correctional authorities with sentences of more than one year.

“Prisons simply are not physically designed to accommodate the infirmities that come with age,”

Reform

# AGING POPULATION

“the number of people in prison requiring significant age-related medical care has risen and **will continue to rise** at a substantial rate given existing population trends.”

We have now reached what Fordham University Professor Tina Maschi calls a “critical Omega point”<sup>5</sup> in which both the sheer number and the specialized needs of the aging prison population have begun to surpass correctional facilities’ capability to provide effective and humane care.



\*Companion aides\* share a room with elderly prisoners at Devens. Some low-security inmates are tasked with caring for elderly prisoners.

Reform

# AGING POPULATION

Approximately 40% of inmates 55 and older have a diagnosis of cognitive impairment.

As of 2007, less than 5 percent of state correctional institutions in the U.S. provided any form of geriatric-specific services, and there are currently few evidence-based models targeting aging individuals within correctional facilities.

# AGING POPULATION

Approximately 40% of inmates 55 and older have a diagnosis of cognitive impairment.

What can Arkansas do...??

Aging in house vs. Parole / compassionate release

- In-house hospice programs. This benefits both inmate-caregiver and the aging population.
- Cognitive Impairment diagnosis training for officers and staff.
- Assisted Living wings or facilities.



# AGING POPULATION

The facility includes 1,440 beds in general population housing, *128 beds in mental health housing, 100 beds in assisted living housing, 27 beds in the hospice/infirmary,* 48 in segregated housing, and 200 beds in outside minimum security housing.



Reform



# RE-ENTRY PROGRAMS

Facilities that look more like a home and less like a jail...

Location....Location...Location.....close to inmates family, support group, and job.

Public transportation is a key factor in planning.

- Local Re-Entry houses.
- Senior Ex-Offender Programs – similar to SEOP based in San Francisco.
- Long-Term Offender Program.

# STAFF RECRUITMENT AND RETENTION

A nice environment helps to keep staff safe and comfortable.

*"The extent to which daylight exposure impacts office workers is remarkable,"*



# STAFF RECRUITMENT AND RETENTION

DAY ROOM



MAIN CONTROL

# MODIFIED BEHAVIOR

Inmates and Staff

## MAIN BOOKING

- Natural Light
- Carpet
- TV's
- Telephones
- Private Bathroom



Design



# MODIFIED BEHAVIOR

# Inmates and Staff

## DAY ROOMS

- Natural Light
- Carpet
- TV's
- Telephones



# Design

# LOCAL EXAMPLES



Design



# LOCAL EXAMPLES



Design

# LOCAL EXAMPLES



Design



# LOCAL EXAMPLES



Design

# LOCAL EXAMPLES



Design



# LOCAL EXAMPLES



Design

# LOCAL EXAMPLES



Design



"WE CAN'T SOLVE  
PROBLEMS BY USING THE  
SAME KIND OF THINKING  
WE USED WHEN WE  
CREATED THEM."

ALBERT EINSTEIN

THROUGH ALL OF MY RESEARCH AND  
PRACTICAL EXPERIENCE, I HAVE COME  
TO ONE REALIZATION....

EVERYONE IS DIFFERENT...

THE SUCCESSFUL PROJECTS SPENT A  
CONSIDERABLE AMOUNT OF TIME  
RESEARCHING AND PLANNING  
AND STUDYING..



VACANT 'BIG-BOX' STORES  
APPROX. 100,000 S.F.

VACANT SCHOOL  
CAMPUSES

WAREHOUSES AND  
WAREHOUSE DISTRICTS

# OPPORTUNITIES

Design

*WALMART CURRENTLY HAS APPROX.  
130,000 S.F. (2 LOCATIONS) OF  
BUILDING FOR LEASE IN  
ARKANSAS....ROUGHLY ENOUGH  
FOR 450 INMATES....*



Short-term



*WHAT IS OUR INTENT FOR  
INCARCERATION...???*

LAST SLIDE....